

Cupertino Pendant

CO1534 1.0

VISUAL COMFORT & Co.

STUDIO COLLECTION

GENERAL PRODUCT INFORMATION:

These fixtures are intended to be installed utilizing NEC compliant junction boxes.

This product is safety listed for wet locations.

Incandescent version may be dimmed with a standard incandescent dimmer.

LED version may be dimmed with a LED dimmer. Consult lamp manufacturer for additional information.

CAUTION - RISK OF FIRE

This product must be installed in accordance with the applicable installation code by a person familiar with the construction and operation of the product and the hazards involved.

SAVE THESE INSTRUCTIONS!

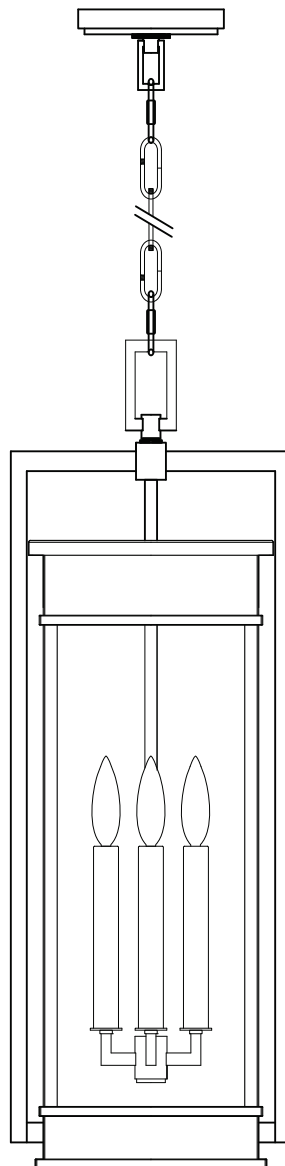

Install the Fixture

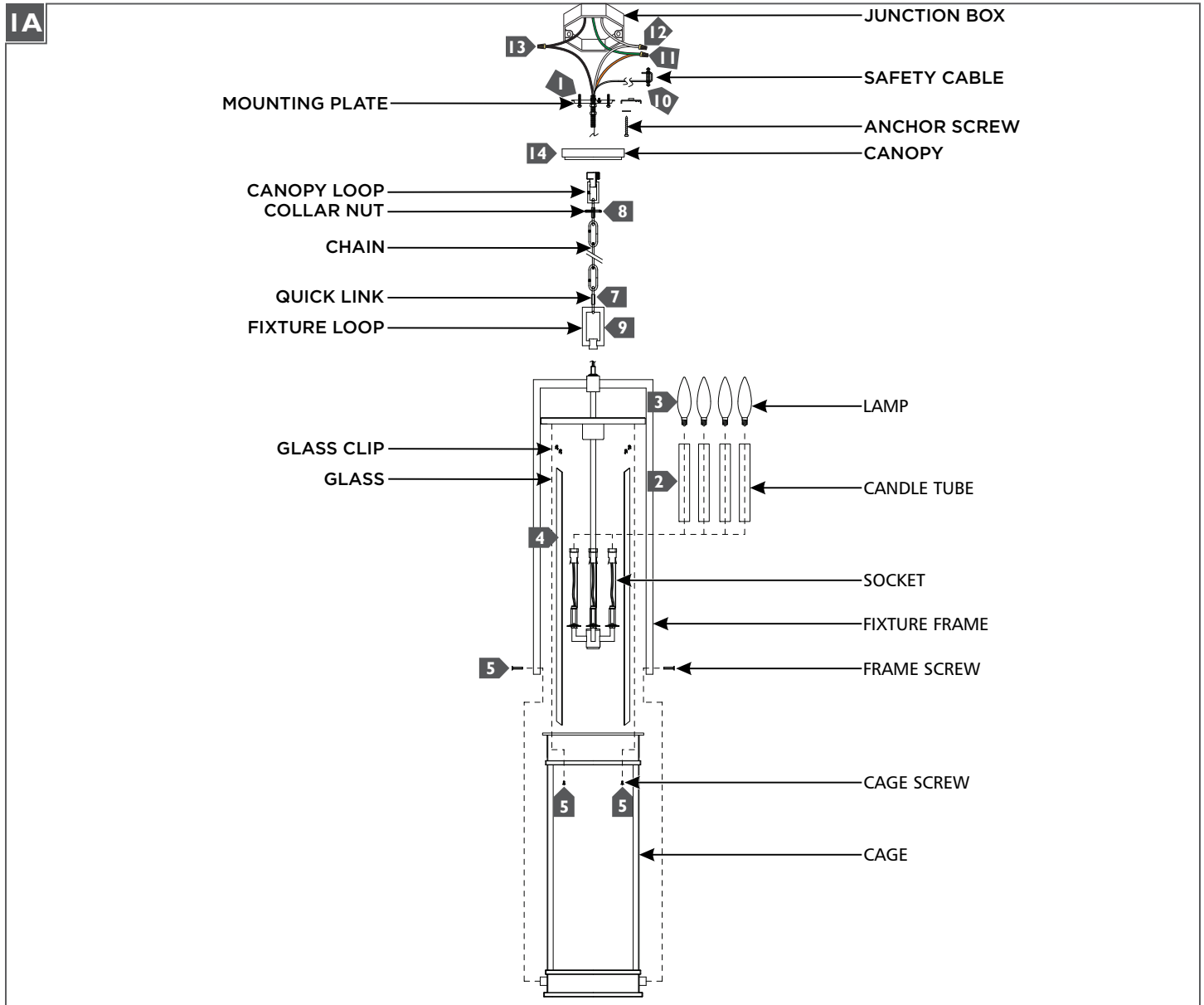

- 1** Secure the mounting plate to the junction box.
- 2** Install the candle tubes on to the socket assembly.
- 3** Screw the lamp into the socket. Refer to the label on the lamp socket for Max Wattage Information.
- 4** Install the glass panels into the cage and secure them in place with the glass clips.
- 5** Install the glass and cage by sliding into the frame over the socket assembly. Secure the cage to the top of the frame with the provided cage screws. Then secure the frame and cage together with the frame screws.
- 6** Determine the wanted height of the fixture and remove a portion of the chain from the bottom by opening a link with pliers.
- 7** Install a quick link to bottom end of the chain, then secure the link onto the fixture loop.
- 8** Install a quick link onto the remaining end of the chain, then secure the quick link onto the canopy loop.
- 9** Weave the cord and safety cable through the chain, collar nut, canopy loop, and canopy, and out of the junction box. Trim the cord leaving enough to make electrical connections.
- 10** Secure the safety cable to the joist with the anchor screw.
- 11** Connect the fixture to a suitable ground in accordance to local electrical codes.
- 12** Connect the white fixture wire (square and/or rigid) to the neutral power line wire with a wire nut.
- 13** Connect the black fixture wire (round and/or smooth) to the hot power line wire with a wire nut.
- 14** Neatly place all the wires into the junction box, place the canopy onto the mounting plate, and secure it in place by threading the collar nut onto the screw collar.